

LUXeye Sense 10A BT

LUXeye Sense 10A BT | Light management systems



Areas of application

- Offices
- Conference rooms
- Training rooms
- Corridors
- Surface mounting via LUXeye SENSE CM KIT

Product family benefits

- Automatic start of light regulation after power-on (out of the box function)
- Basic functionality without configuration thanks to applied pre-settings
- Easy and fast customization of important parameter via screwdriver
- $V(\lambda)$ corrected light sensor element
- Predefined and customizable configurations for all applications
- Password protection for user and configuration APP access
- Easy report generation of all commissioned sensors
- Easy report sharing via email
- DEMO Mode usable without device

Product datasheet

Product family features

- 10 A output relay for ohmic, inductive and capacitive load
- Daylight-dependent switching and presence-dependent control of light
- Operation via standard pushbutton
- Outputs with electronical reversible short-circuit and overload protection
- Change of delay time with screwdriver direct at the sensor
- Change of switch off level with screwdriver direct at the sensor
- Halogen free polycarbonate plastic housing
- Controller with integrated light and presence sensor, relay, Bluetooth interface
- Presence detection via passive IR element
- Light control via smart phone
- Adjustment of all settings via smartphone
- Function indicator with three color LED
- Individual activation and deactivation of light and presence sensor
- Various shutters included for different detection areas

Product datasheet

Technical data

Electrical data

Nominal voltage	220...240 V
Mains frequency	50...60 Hz
System wattage	0.55 W

Dimensions & weight

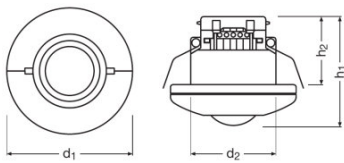

Diameter	95.0 mm
Height	81.0 mm
Product weight	157.00 g
Mounting hole spacing, diagonal	68...80 mm

Colors & materials

Product color	White
---------------	-------

Temperatures & operating conditions

Ambient temperature range	0...+55 °C
---------------------------	------------

Capabilities

Transmitter range	15 m
Maximum installation height	5 m
Detection area	10 m ¹⁾
Detection angle	110 °
Load contact	10 A
Type of installation	Ceiling integration
Operating range, light sensor	20...5000 lx ²⁾
Overheating protection	Yes

¹⁾ Diameter for movement detection at 5 m installation high

Product datasheet

2) Approximately, measured at the sensor

Certificates & standards

Type of protection	IP20
Protection class	II

Logistical data

Commodity code	853710989900
----------------	--------------





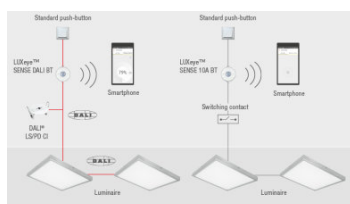

Equipment / Accessories

- Free App for iOS and Android
- Suitable for 10 A R/L/C load similar to 10 A fuse (B)



Circuit diagram

Download Data

File	
	User instruction 728510_LUXeye Sense 10A BT User Instruction
	Declarations of conformity 9C1-3433399-EN-01 LUXEYE SENSE (EN)
	CAD data Luxeye Sense STEP 111119
	CAD data Luxeye Sense IGS 111119
	CAD Data 2-dim Luxeye Sense CAD2PDF 111119
	CAD data 3-dim Luxeye Sense CAD3PDF 111119
	Product movie 729682_How to install LUXeye (EN)

Product datasheet

Logistical Data

Product code	Product description	Packaging unit (Pieces/Unit)	Dimensions (length x width x height)	Volume	Gross weight
4052899957428	LUXeye Sense 10A BT	Shipping carton box 12	495 mm x 265 mm x 192 mm	25.19 dm ³	3441.00 g

The mentioned product code describes the smallest quantity unit which can be ordered. One shipping unit can contain one or more single products. When placing an order, for the quantity please enter single or multiples of a shipping unit.

Disclaimer

Subject to change without notice. Errors and omission excepted. Always make sure to use the most recent release.

HOANG KHAI DANG COMPANY LIMITED

The Importer and Distribution of lighting equipment OSRAM

Head office: 44 Nguyen Dinh Chieu, Da Kao Ward, District 1, Ho Chi Minh City, Viet Nam.

Tel: 028 3910 6667 - 028 3910 7778

Mail: hoangkhaidang@hkd.com.vn Website: <https://hkd.com.vn>

Facebook: <https://www.facebook.com/ledosram>

Hotline: **090 3030 555**