

BackLED ECO M Plus

LED modules for light advertising and backlighting



Areas of application

- Backlighting of medium size channel letters

Product benefits

- Type of protection IP64 thanks to full encapsulation of LED modules
- Illumination without hotspots with less modules, slim depths due to batwing optics
- Consistent white light (Standard Deviation of Color Matching SDCM: < 3)
- Completely molded housing protects PCB and LEDs
- Easier pre-mounting with double-sided tape with extra long foil

Product features

- Chain of 40 LED modules with three LEDs each
- Connected with flexible cables
- Variable LED module distance of 120...200 mm
- Very homogeneous backlighting with installation depth of 60 mm
- Dimmable with OT DIM, OT DALI DIM, OT DALI DIM LI
- Lifetime (L70/B50): 30,000 h (temperature at $T_c = 70^\circ\text{C}$)
- Color rendering index R_a : > 80



Product family datasheet

Technical data

Electrical data

Product description	Nominal voltage	Nominal wattage per LED module	Input voltage range	Type of current
BA-ECO-M-PL 865	12.0 V	0.72 W	12...13 V	DC

Photometrical data

Product description	Light color (designation)	Light color LED	Luminous flux per module chain	Luminous efficacy
BA-ECO-M-PL 865	Cool Daylight	White	2880 lm	100 lm/W

LED module information

Product description	Number of LEDs per module	Number of LED modules per chain	Minimum operable number of LED modules
BA-ECO-M-PL 865	3	40	1

Dimensions & weight

Product description	Product weight
BA-ECO-M-PL 865	265.00 g

Product line drawing

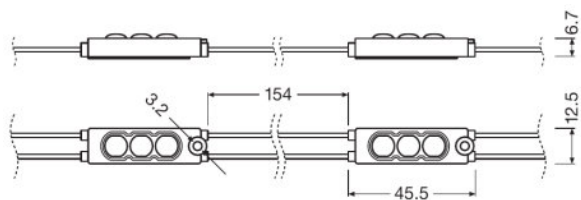

BA-ECO-M-PL 865

Temperatures & operating conditions

Product description	Temperature range in operation [PIM]
BA-ECO-M-PL 865	-25...70 °C ¹⁾

¹⁾ At the T_c point

Capabilities

Product description	Dimmable
BA-ECO-M-PL 865	Yes

Certificates & standards

Product description	Type of protection	Standards
BA-ECO-M-PL 865	IP64	Acc. to IEC 62471/Acc. to IEC 60598-1/Acc. to EN 60529/Acc. to EN 62031/Acc. to EN 55015/Acc. to EN 61547

Product family datasheet

Logistical data

Product description	Temperature range at storage
BA-ECO-M-PL 865	-25...80 °C

Equipment / Accessories

- Optimised for operation with OPTOTRONIC 12 V power supplies



Application advice

For more detailed application information and graphics please see product datasheet.

Sales and Technical Support

Sales and Technical Support www.osram.com

Download Data

File
 Declarations of conformity 727530_EC BackLED PLUS
 Declarations of conformity 727532_Manufacturer's Declaration BackLED PLUS
 IES data BackLED Eco M Plus

Logistical Data

Product code	Product description	Packaging unit (Pieces/Unit)	Dimensions (length x width x height)	Volume	Gross weight
4052899392465	BA-ECO-M-PL 865	Shipping carton box 5	255 mm x 160 mm x 188 mm	7.67 dm ³	1572.00 g

The mentioned product code describes the smallest quantity unit which can be ordered. One shipping unit can contain one or more single products. When placing an order, for the quantity please enter single or multiples of a shipping unit.

Disclaimer

Subject to change without notice. Errors and omission excepted. Always make sure to use the most recent release.